



## 1070A Combination Spring and Deadlock / 1070AK.a Combination Spring and Deadlock



# Mechanical Locks



For More information please call 210-123-4567

# Mechanical Locks

1070A Combination Spring and Deadlock

1070AK.a Combination Spring and Deadlock



1070A-1: KEYED ONE SIDE  
1070A-2: KEYED BOTH SIDES

## APPLICATION

For high security swinging doors where slamlocking is desired.

## FUNCTION

Key activated unlocking. Automatically snaplocks and deadlocks upon closing. Latchbolt unlocks with a half turn of the key.



1070AK.a-1: KEYED ONE SIDE  
1070AK.a-2: KEYED BOTH SIDES

## APPLICATION

For high security swinging doors where slamlocking is desired along with the convenience of knob operation in areas where manual deadlocking with a key is desired.

## FUNCTION

Automatically snaplocks and deadlocks upon closing. Knobs unlock with a 1/2 turn of the key. Quarter turn of the key in the opposite direction deadlocks the knobs. Knob will retract the latchbolt in both directions, except when deadlocked. One side or two knob operation.

## OPTIONAL FEATURES

HOLLOW METAL MOUNTING - Used for hollow metal door application. Specify "HM."

GRATING DOOR MOUNTING -  
Used for grating door application. Specify "G."

PLATE DOOR MOUNTING - Used for steel plate door application. Specify "P." 470CL Bolt Keeper with switch

GRATING DOOR MOUNTING -  
Used for grating door application. Specify "G."

## STANDARD FEATURES

- Mechanical deadlock
- Six heavy-duty tumblers
- Mounting fasteners
- 470C Bolt Keeper with dust box

For More information please call 210-123-4567



# Mechanical Locks

## 1070A Combination Spring and Deadlock 1070AK.a Combination Spring and Deadlock

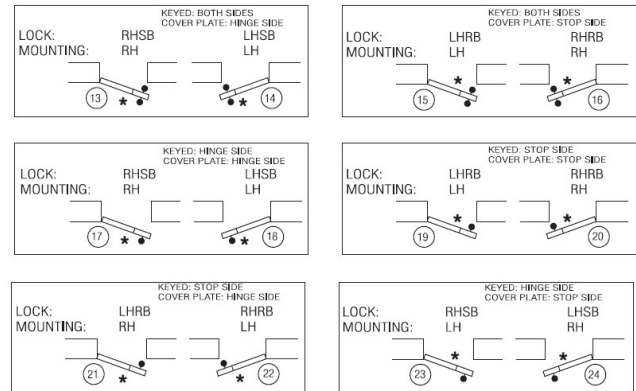
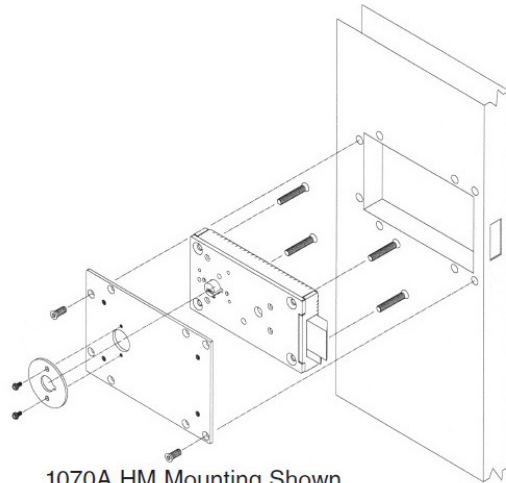

\* Indicates lock mounting/access plate side.

**Swing Chart:** Specify circled swing number when ordering.

## TECHNICAL DATA

Standard Finish	Galvanized
Cover	Steel
Case	Steel
Deadlock Actuator	Stainless Steel
Paracentric Cylinder	Silicon bronze/ copper alloy
Tumblers	6 tumblers per lock
Lock Size	9" L x 5" H x 1-1/2" TK
Lock Weight	11 lbs
Lockbolt Size	2" H x 3/4" TK
Lockbolt Throw	3/4"
Latchbolt	Stainless steel with (2) 1/4" diameter case-hardened steel insert pins

UL Listed for use on three hour fire doors.  
ASTM F1577 Certified Impact Test-Grade 1



For More information please call 210-123-4567